

300mm Barcode & Vision System

# RAD-5000VS12



## Outline

- Fully-automatic barcode label printing and attachment system, used after wafer ID is recognized via monitor.
- Ability to read attached barcode label for checking.
- Ability to operate in-line with Lintec's fully-automatic wafer mounter.

Option ·Host Communication Function (Communication Format :  
Conforms to SECS-I and HSMS/Software : Conforms to GEM)

## External View

## Facility

<b>Power Supply</b>	Voltage	: AC200-230V ±10% (AC190-253V)
	Frequency	: 50/60Hz
	Phase	: single phase
<b>Air Supply</b>	Power consumption	: 1.0kW
	Air pressure	: 0.5-0.8MPa
	Air consumption	: >200L/min (ANR)
<b>Vacuum Supply</b>	Vacuum pressure	: >-80kPa

**Applicable Wafer Size** 200mm, 300mm

**Size** Width : 1,300mm  
Depth : 1,500mm  
Height : 1,850mm  
(excluding the signal tower)

**Weight** 1,000kg

**UPH** 80wafers/hour  
(This may vary depending on character position and printing frequency.)

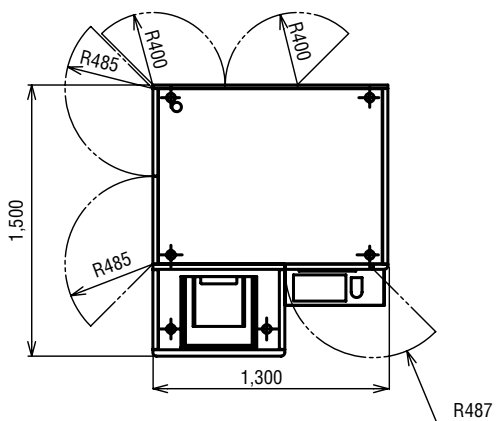

Top View

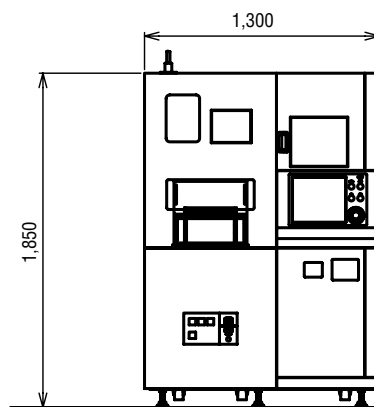

Front View

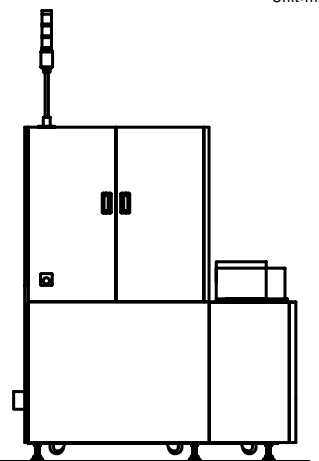

Left Side View

Unit:mm



**LINTEC Corporation** *Linking your dreams*

●Head Office:23-23 Honcho, Itabashi-ku, Tokyo 173-0001, Japan

Contact:Advanced Materials Operations 8th Fl., Bunkyo Garden Gate Tower, 1-1-1 Koishikawa,  
Bunkyo-ku, Tokyo 112-0002, Japan  
TEL. +81-3-3868-7737 FAX. +81-3-3868-7726

<https://www.adwill-global.com/en>